

Egmont A&P  
Association

**20<sup>th</sup> – 22<sup>nd</sup> November 2025**



**EQUESTRIAN SCHEDULE**

# **Our People**

**President** Dale Moseley

**Patron** Malcolm Hurley

## **Executive Committee**

Vice President – Georgina Maud

Honorary Solicitor - Halliwells Barristers and Solicitors

Treasurer – Tom Butler

David Turner, William Brewer, Andrew Corrigan, Walter Smyth, Richard Brewer,  
Ben Abbott, Malcolm Hurley, Alex Corrigan,

## **Show Committee**

Jocelyn Baldwin, Claire Norton, Stephen & Lynette Gopperth, Gerardine Wood

## **Honorary Life Members**

Athol Curtis, Diane Jellyman, Cate Thomson, Graham Johnson, Lesley Pease,  
Julie & Donald Williamson, Tui & Michael Steele,  
Hazel Robinson, Richard Brewer, Wayne Bigham, Walter & Linda Smyth,  
William Brewer, Phil Dickey & Jen Blyde

## **Staff**

Office Administrator – Angela Pennefather

Caretaker/Grounds man – Walter Smyth

## **Equestrian Stewards**

Walter Smyth, Dale Moseley, Dressage Taranaki, Taranaki Equestrian Jumping,  
Ray Egarr

# Equestrian Timetable

## **Thursday 20<sup>th</sup> November**

**8.30am Main Oval - Dressage**

## **Friday 21<sup>st</sup> November**

**Obertech Group Ring 1 Main Oval - Showjumping**

8.00 am - Classes 1 - 6

**Ring 2 Main Oval – Showjumping**

8.00 am - Classes 7 - 11

**Ring 3 Burnside Grass – Showjumping**

8.00 am – Classes 12 - 18

**Sideshow Alley – Show Hunter Horse**

8.30am – Classes 39 - 45

**Show Hunter Pony**

Classes 46-56

## **Saturday 22<sup>nd</sup> November**

**Obertech Group Ring 1 Main Oval - Showjumping**

8.00 am – Classes 19 - 24

**Ring 2 Main Oval - Showjumping**

8.00 am - Classes 25 – 29

**Ring 3 Burnside Grass – Show Jumping**

8.00am – Classes 30 – 38

**Sideshow Alley – Show Hunter Pony**

8.00am – Classes 57-67

**Show Hunter Horse**

Classes 68-74

# Egmont A&P Association Membership

## JOIN THE EGMONT A&P ASSOCIATION TODAY!

Egmont A&P Association members assist us in achieving our goals of connecting communities, promoting our people and produce and inspiring our primary sector to be the best it can.

"In the community, for the community, by the community"

We are a not-for-profit charitable organisation and having a dedicated membership base is essential for the A&P Assn to help enable us to undertake our activities during the year.

Annual Membership runs from 1 July to 30 June each year.

- Individual Membership \$40.00 per year
- Family Membership \$60.00 per year

As an Association member you will receive:

- Access to our grounds
  - Preferential bookings of all our facilities
  - A & P Show Entry
  - Exclusive pass to the Members carpark at the Show
  - Entry to our Members & Sponsors Lounge
  - Have your say at our AGM
  - Keep informed of what is going on at the Showgrounds via our Newsletter
- 

For more information, please contact the office on 06 2788613 or [info@egmontshowgrounds.org.nz](mailto:info@egmontshowgrounds.org.nz) or visit [www.egmontshowgrounds.org.nz](http://www.egmontshowgrounds.org.nz) to join!

# Thank you to all our sponsors for our 2025 Equestrian Event

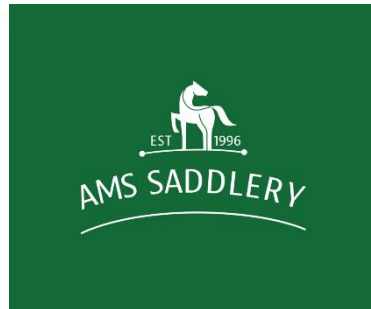



*WT & LM Smyth*







## Taranaki Bulk Spreaders



# **Egmont A&P Show General Conditions**

**Dressage entries close at midnight Thursday 6<sup>th</sup> November**

**Show Jumping & Show Hunter entries close midnight Sunday 16<sup>th</sup> November**

**RAS Section entries close Sunday 16<sup>th</sup> November 2025**

Any correspondence regarding our event please contact the show secretary Wendy Knight:  
**[entriesegmontshowequestrian@gmail.com](mailto:entriesegmontshowequestrian@gmail.com)**

The following General Conditions are to be read in conjunction with Section Conditions and with the Rules and Bylaws of the Royal Agricultural Society (RAS) of New Zealand.

## **1) PRIVACY ACT**

The A&P Society holds records of names and addresses of all Members, Trade Exhibitors and Competitors and may publish these for the purposes of Show media reports or promotional purposes at the A&P Associations discretion.

The A&P Association may take photographs and video images of Members, Trade Exhibitors, Competitors, exhibits (including livestock) and the employees, agents and assistants of any Trade Exhibitor or Competitor and use this information for reporting or promotional purposes in any media, at the A&P Associations discretion.

## **2) HEALTH & SAFETY**

Competitors must:

- Comply with the appropriate animal legislation and the Health and Safety at Work Act 2015 and any amendments thereafter.
- Supervise and control their animals at all times and shall be liable for any hazards created or accident, illness or damage caused by the action of themselves or their animals at the Showgrounds. The Association reserves the right to order immediate removal from the Showgrounds any animal it considers unruly, dangerous or unmanageable.
- Follow the instructions of Marshals and Officials.
- Ensure that they keep walkways clear, and no dangerous equipment or chemicals are accessible to the public.
- Report accidents to the Show Office.

***NO SMOKING or VAPING inside any buildings within the Egmont A & P Showgrounds.***

All persons admitted into any premises controlled by the Egmont A&P Association shall be subject to the orders of the Committee and, in the event of misbehavior on the part of anyone attending the Show such person may be removed by order of the Association. This applies to any person whose conduct, either personal or as proprietor of a trade stand, or exhibit, is a source of annoyance.

The Egmont A&P Association will not be responsible for any accident, loss or damage that may be caused directly or indirectly to or suffered by an exhibit.

Persons occupying grandstands, buildings and other structures or other seating accommodation on the Showgrounds do so at their own risk.



The full Health & Safety Policy & Management Plan is available at the Show Office.

## **2.1) First Aid**

First aid stations are located by the Office. Please familiarize yourself with the Showgrounds site map.

## **2.2) Protective Headgear/Safety Helmets**

Wearing a helmet (with a yellow tag) is compulsory for anyone competing on, working in or schooling or riding for any reason a horse within the Showgrounds. Such headgear must be worn with the chinstrap properly adjusted and fastened when in the arena or ring, the practice area, collecting rings or anywhere else within the Showgrounds.

The RAS, Equestrian Sports New Zealand (ESNZ) and NZ Pony Club Association (NZPCA) have a consistent standard in approved safety helmets and use the same yellow safety tags to identify compliant helmets. Some A&P Shows and measuring stands can tag compliant helmets and any yellow tag applied by the ESNZ or NZPCA is accepted by the RAS. All helmets that conform must be identified by the current tag system.

NOTE: New 'yellow' Tags regulations come into force on 1 August 2023. For more information, please follow these links: <https://www.ras.org.nz/equestrian/health-and-safety/> or <https://www.nzequestrian.org.nz/safety/helmettagging/>

## **2.3) FALL OF RIDER**

- If a rider has a fall or suspected head injury, at any time at an RAS affiliated Show/Event in the ; competition ring/arena, practice/warm-up/collecting ring/arena; or elsewhere within the grounds of where the show is being convened, the rider must be removed from the activity and checked by the show/events nominated First Aid service/personnel and be given the 'all-clear' before the rider is permitted to re-mount and continue riding at the show/event.

## **3) RIGHTS OF THE EGMONT A&P ASSOCIATION**

The Egmont A&P Association reserves the right to, at any time, for any reason and without notice to:

- Refuse or cancel any entry
- Alter the Show timetable
- Withdraw or change any event or class
- Amalgamate classes where there are insufficient entries
- Remove any dangerous or inappropriate exhibit or display

The decision of the Association is final. Competitors will be notified if classes are to be amalgamated.

## **4) CONDITIONS OF ENTRY**

- Entries for all Equestrian Sections are to be submitted by entering on Evo Events; [www.evoevents.co.nz](http://www.evoevents.co.nz),
- Entries are not accepted until they are paid in full.
- Entries received after closing date will only be accepted at the discretion of the organisation and will incur a late fee of \$25.00
- There is no receipt of entry unless requested.
- It is the competitor's responsibility to ensure their details of entries are correct.
- Entry in the Show entitles the Egmont A&P Association to publish a competitors' name in results and distribute with Competitor Lists.
- The Association reserves the right to refuse or cancel any entry without adducing any reason for doing so.

| Competitor Entry  | Fee     |
|---|---------|
| Ground Levy Per horse   | \$20.00 |
| Medical & Admin levy per rider<br>( Non refundable)   | \$20.00 |
| Camping Fee per Truck/ Float<br>(Unpowered)<br>* there are no powered sites available<br><b>per night</b> | \$15.00 |
| Covered Yard/Stable for<br><b><u>per day or night</u></b>   | \$18.00 |
| Open yard for <b><u>per day or night</u></b>  | \$14.00 |

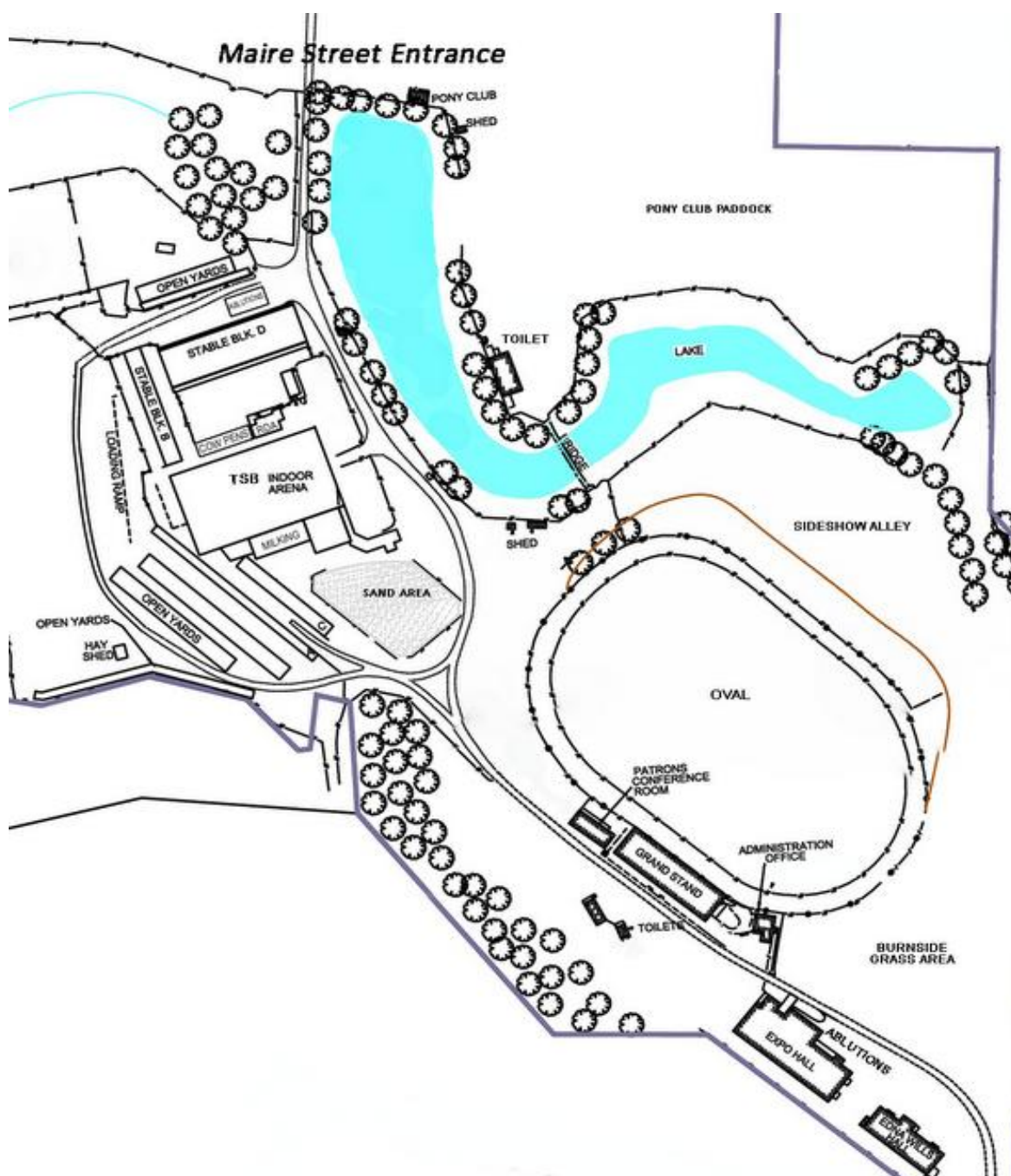

## 5) SCRATCHINGS

- Application for refunds must include a vet certificate or medical certificate.
- 100% refund will be paid until close of entry, excluding Evo & credit card fees which are non refundable
- 50% refund will be paid from close of entry, excluding Evo & credit card fees which are non refundable
- Competitors are encouraged to do their scratching's via My Entries on Evo Events AND notify the Office.

## 6) PARKING

- ALL equestrian vehicles MUST enter via Maire Street Entrance
- ***Double gates by Norfolk Pine tree are to be kept closed at all times***
- No parking around the horse stalls
- Exit using Maire Street

## 7) ACCOMMODATION

- Camping fee of \$15.00 per truck or float per night **\*\* There are no powered camping sites available\*\***
- Showers and toilets are provided.

## 8) STABLING/YARDING

- Stables and yards cannot be guaranteed as they are limited.
- Temporary yards are NOT permitted. This includes taped areas at the truck or float.
- Stallion boxes must have sign denoting "STALLION" on outside of box.

### 8.1) Stabling/Yarding Bond

- Stabling/ yarding will be issued in order of entry with preference to visitors, organising committee, sponsors, volunteers and those competing at a higher level.
- On arrival all yards and stables will be clean.
- It is the responsibility of the competitor that has been allocated the yard/stable to keep the yard/stable clean and free of rubbish.
- All wet & dirty straw, sawdust etc must be removed from the yard/stable and cleaned out at the conclusion of the Show.
- Competitors are to take photographic evidence prior to departing, please only send these photos in if requested where there is a dispute.
- An Egmont A&P Association Official will be assessing the state yards and stables are left in by the occupying competitor, after the Show. If the yard/stable is not left in satisfactory condition, photographic evidence including yard/stable number will be taken and the competitor will be invoiced \$75.00 and may not have a yard / stable allocated to them in the future.

## **9) RULES**

- ESNZ rules apply to all Dressage and Show Jumping competitors.
- RAS rules apply to all showing, sport and pleasure horse competitors.
- The RAS Judges & Competitors Rulebook (see [www.ras.org.nz](http://www.ras.org.nz)) sets out all the conditions that apply to the classes and sections offered.
- Should any person or firm be disqualified or suspended by another Association or affiliated organisation of the Royal Agricultural Society, the suspension or disqualification may also be applied by the affiliate organisations.

## **10) STARTING TIMES**

- Starting times are approximate only but the Show will endeavor to adhere to as closely as possible. When a competitor may have two classes they have entered running simultaneously then they must elect which class they compete in. Our judges and stewards will do their best to work in with everyone to the best of their ability.
- To be read in conjunction with the relevant section conditions and rules and By-Laws of the Royal Agricultural Society of New Zealand.

## **11) LATE ENTRIES & CHANGES DURING THE SHOW**

- Late entries will only be accepted at the discretion of the organisation and will incur a late fee of \$25.00
- Competitors can place additional/change entries during the Show for the following day's events. These entries MUST be made at the Horse Office by 5pm the day prior to the competition to allow for alterations of the judging sheets. A 25% surcharge may apply and must be paid at the time the additional entry is made. These riders will go first in the class where it is draw order.
- Substitutions are permitted provided the original equine that is being substituted, takes no further part in this Show. The substitution can only be made into the same class as the original entry and be owned by the same person. Vet certificates are not required. Substitutions MUST be made at the Show Office by 5pm the day prior to the competition to allow for alterations of the judging sheets.

## **12) PROTESTS**

- All protests must be in writing and may be lodged with the Section Chief Steward/Section Head one hour from the completion of the class judged, together with a deposit of \$50 which shall be returned should the protest be upheld. No protest will be received later than one hour after the ribbons are affixed.

## **13) TROPHIES & CUPS**

- All Cups and trophies will be available for awarding and photography purposes ONLY and will be engraved at the Egmont A & P Associations expense.
- No Cups and trophies are to leave the Egmont A&P Showgrounds.

## **14) PREPARATION FOR DEPARTURE**

- Clean out all yards/stables, as you found them – refer to 'Yard/Stabling Bond' pg. 11
- Notify the Office of any damage or repairs and maintenance required.
- Remove all rubbish and personal belongings.
- Check your individual schedules for any specific details related to the section.
- Pay all outstanding fees before departing the Showgrounds.

## **15) PRIZE MONEY**

- Any prize money will be paid into a nominated bank account within 30 days (subject to any queries). Please enter this into Evo Events when entering the event.
- Any Prize money or refunds will be paid electronically within 30 days of the event into your nominated bank account on Evo Events, please ensure this is current and verified when making your entry.
- Any disputes regarding prize money must be made no later than 30 November 2025.
- The payout scale for RAS sections:
  - a. In classes with three (3) or less entries, only 1<sup>st</sup> place will be awarded and paid.
  - b. In classes with four (4) to six (6) entries, 1st and 2nd place will be awarded and paid.
  - c. In classes with seven (7) or more entries, all prize money will be awarded and paid.
- For Show Hunter and non ESNZ series Show Jumping classes, prize money as per Article 248.7.

## **16) REFUND POLICY**

The Committee reserve the right to request a veterinarian or Doctors certificate if any competitor requires a refund. Application for refunds to be in writing within 14 days of the show. 75% of entries fees only will be refunded, excluding EVO and credit card fees, no refunds under \$20 will be made except where grading affects the class.

## **17) BIOSECURITY**

The Egmont A&P Society supports all appropriate biosecurity regulations.

## **18) BEHAVIOUR & CONDUCT – In-Line Resolution Process/ ESNZ Official Warning Card**

- This Show supports the RAS In-Line Resolution Process Policy, which will operate in all sections and will be used for any inappropriate behaviour towards Show officials, judges, fellow competitors or any other third party connected with the Show.
- The full working of the policy is available to view on the RAS website [www.ras.org.nz](http://www.ras.org.nz)
- ESNZ Official Warning Card may be issued, in cases of offences in respect of abuse of animals or inappropriate behaviour as per Dressage NZ, ESNZ Jumping and /or ESNZ Rules and General Regulations Full information on ESNZ Official Warning Card procedure can be found at [www.nzequestrian.org.nz](http://www.nzequestrian.org.nz).

## **19) CLEAN SPORT TESTING**

- The use of tranquilizers, stimulants or any drugs capable of affecting the performance of horses and ponies is forbidden.
- Competitors are advised that tests for forbidden substances may be carried out during the Show and that testing of animals is at the risk of the person that is responsible. Clean Sport testing will be carried out under the RAS (Incorporated) CleanSport Judicial Committee (CSJC) procedures and rules.
- Any competitor who has administered to their horse or pony any drug during seven days prior to the show is required to notify the secretary and fill out a medication advice form before competing.
- ESNZ Blue Card rules for concussion will apply in both Dressage and Jumping Sections.

## **20) WHISKER AND INNER EAR TRIMMING FOR HORSES AND PONIES**

- As from 1 January 2022 there is to be no trimming of whiskers, eye or inner ear hair/whiskers of horses/ponies competing at RAS affiliated A&P Shows/Events. This is in line with the same animal welfare approach taken by the Equestrian Sport New Zealand (ESNZ) and New Zealand Pony Clubs Association (NZPCA). The below link provides more detail on what is and is not permitted.

- <https://www.ras.org.nz/equestrian/whisker-and-inner-ear-trimming/>

## **21) HEIGHT CERTIFICATES**

- The Measuring Rules of the RAS apply to this Show.

- Height certificates and novice status cards **must** be carried at all times and presented on demand otherwise the competitor will not be allowed to start.

- Competitors in any class where a height certificate is required may not leave the ring to obtain a certificate and will forfeit awards if certificate is not shown. Microchips do not exempt riders from carrying a height certificate.

- Competitors are advised of all measuring days and times which are set prior to entries closing for the Show.

- No measuring will be carried out between the closing of entries and the Show.

## **22) STALLIONS AND COLTS**

- All 'day travelling' stallions and colts must be attended to and supervised at all times by an adult OR placed into a stallion box (to be paid for in entries).

- Stallion boxes must have sign denoting "STALLION" on outside of box.

- All stallions and colts (with the exception of miniature horses and foals) must be shown in a bit and it is compulsory for all stallions and colts to wear (2) official "S" identification badges, one attached to each side of their bridle. The rider and handler must also wear (2) official RAS armbands (one on each arm) when in the ring. Badges can be purchased from RAS Head Office or ESNZ and armbands from RAS Head Office.

- Stallion Handlers and Riders must be 17yrs or older and wear an approved Hi-vis vest when outside the showing ring which can be purchased from RAS Head Office.

- Any **ESNZ** stallion must have a person responsible that is at least 18 years of age and display ESNZ stallion tag at all times.

## **23) AGE OF RIDERS, HANDLERS, HORSES & PONIES**

- Riders/Handlers/Horses/Ponies age eligibility is determined as at the 1 August and stays in that division/section for the complete Show year/season. Proof of age may be required and should be on hand.

- Novice pony stallions must be led or ridden by a rider 14 years & over.

- Open pony stallions must be ridden by a rider 14 – 16 years and led handlers must be 14 years & over.

- Stallions over 148cm must be ridden or led by a rider/handler 17 years & over.

- Horses over 148cm must be ridden by a rider 12 years & over (except for stallions).

- Horses/Ponies under three (3) years of age are not permitted in any ridden or driven (harness) class no matter what the rules of any affiliated Breed Society or Kindred Society may prescribe.



# Egmont A&P Show Section Conditions

## Show Hunter

### SIDE SHOW ALLEY – Draw order

#### Conditions of Entry

- Please read these Section Conditions alongside the General Conditions of the Egmont A&P Show.
- Horse of the Year Qualifying Show
- All riders, horses and ponies must compete with the appropriate ESNZ membership to compete in ANY Show Hunterclasses.
- Horses and ponies may compete in Show Hunter under the ESNZ casual levy system but if riding on a casual registration will not be awarded any LRHOY qualifying points.
- Run under ESNZ Show Hunter rules & series conditions.
- Riders may enter only one equitation class per day.
- RAS Show levy of \$1.25 per entry is included in Entry Fee.
- **No Practice rounds**
- Show Hunter Guidelines for Ponies:
  - o Cat A: Ponies 133cm & under 3.05m (10') stride
  - o Cat B: Ponies over 133cm and up to and including 143cm; 3.20m (10'6") stride
  - o Cat C: Ponies over 143cm and up to and including 148cm; 3.35m (11') stride

**Arrival:** Gate entry through Maire Street Gate

## Show Jumping

### OVAL & BURNSIDE GRASS

#### Ring 1 Sponsored by: Obertech Group

#### Conditions of Entry

- Please read these Section Conditions alongside the General Conditions of the Egmont A&P Show.
- These apply to jumping events where applicable, including regulations governing Certificates of Height.
- If classes have excess entries the classes will be divided, and prize money adjusted.
- RAS Show levy of \$1.25 per entry is included in Entry Fee.

#### Time of Events

- Times stated in the Schedule for Jumping Competitions are approximate only and will be adjusted after entries close according to entries received. The Egmont A&P Show reserves the right to start an event before the catalogued time.
- Overlap - Consideration shall be shown to competitors who are entered in competition that may overlap. Please see the Senior Steward concerned but classes will not be delayed.
- In Ring 1, Competitors must jump in the order as drawn and printed in the Catalogue. All riders must be suitably attired when entering the ring.
  - Ring 1 to be run in draw order.
  - Ring 2 blackboard order
  - Ring 3 black board order

## **ESNZ**

- All riders must be ESNZ registered.
- For all classes, (except introductory classes) riders must have a full ESNZ membership, horses must be registered with ESNZ and have a current ESNZ Jumping annual start.
- ESNZ fees will be charged as per ESNZ guidelines on Evo Events.
- Intro Horses are restricted to .90m and under.
- Intro Ponies are restricted to .80m and under.
- Horses and Ponies cannot compete in Series Classes with Casual Start.
- Classes are run under ESNZ Rules and Regulations. For conditions of the series classes please visit [www.nzequestrian.org.nz](http://www.nzequestrian.org.nz)

## **Egmont Horse Coaches Pony Points Prize**

The Egmont Horse Coaches Pony Points Competition is held over the Taranaki Show jumping circuit in selected classes beginning at Waverley A&P, Egmont A&P, Taranaki Equestrian Jumping & Egmont Horse Coaches Spring Spectacular, and ends at the Taranaki Equestrian Jumping Show in March. Points are allocated 5,3,2,1 at each show and the "John Henry" cup is presented to the leading Taranaki rider at the completion of the series.

## **Taranaki Equestrian Jumping Horse Points Prize**

The TEJ Horse Points Competition is held over the Taranaki Show jumping circuit for Taranaki Riders only in selected classes beginning at the Egmont A&P(90cm), Taranaki Equestrian Jumping Spring Spectacular(90cm), and ends at the Taranaki Equestrian Jumping Show in March(1m &1.05). Points are allocated 5,3,2,1 at each show and the Hamlyn Family cup will be presented to the leading Taranaki rider at the TEJ end of season dinner.

**Arrival:** Gate entry through Maire Street Gate



## PONY CLUB Paddock

### Conditions of Entry

- Please read these Section Conditions alongside the General Conditions of the Egmont A&P Show.
- The use of prefixes on horses and ponies in the showing classes be those of the breeder.
- Where classes are defined by height, competitors/exhibitors must carry a current RAS Certificate for their horse/pony at all RAS affiliated Shows/Events, and must produce it upon request to any authorised Show/Event personnel. Any competitor unable to produce such a certificate means that the exhibit is ineligible to compete, and will forfeit any awards.
- If sections coincide no class will be delayed.
- RAS Exhibit Numbers showing classes - It is compulsory to display your exhibit number (exhibitor to provide, except Working Hunter & Hunter Jumping) while in a RAS judging ring. This can be in a number holder or make your own armband which is worn on left arm.
- The number of Novice wins is to be counted at the time of the Show/Event, not the time of entry. If a Novice entry exceeds the permitted number of wins by the day of the Show/Event, the competitor must advise the Secretary's Office and change to an Open class, or if no class remains to enter, a refund will be actioned after the Show/Event.
- Imported Horse/Pony - Any wins gained overseas by a horse/pony that is imported into New Zealand, count towards their classification when showing in New Zealand, i.e. whether it can still compete in the Novice section (5 wins or less) , or if it has 6 or more wins, then it must compete in the Open section.
- RAS Show levy of \$1.25 per entry is included in Entry Fee.

**Arrival:** Gate entry through Maire Street Gate

| <b>Friday 21<sup>st</sup> November</b><br><b>Time</b> | <i>Ring One</i><br><i>Judge:</i> | <i>Ring Two</i><br><i>Judge:</i> |  |
|---|----------------------------------|----------------------------------|--|
| 10am  | Working Hunter Pony              | Led Horse                        |  |
|   |                                  |                                  |  |
|   | Hunter Jumping Pony              | Led Pony                         |  |
|   | LUNCH                            |                                  |  |
| Not before 1pm  | Working Hunter Horse             |                                  |  |
|   |                                  |                                  |  |
|   | Hunter Jumping Horse             |                                  |  |

| <b>Saturday 22<sup>nd</sup> November</b><br><b>Time</b> | <i>Ring One</i><br><i>Judge:</i> | <i>Ring Two</i><br><i>Judge:</i> | <i>Ring Three</i><br><i>Judge:</i> |
|---|----------------------------------|----------------------------------|------------------------------------|
| 8.30am  | Novice Horse                     | Novice Pony                      | Show Pleasure Pony                 |
|   | Novice Pony Challenge            | Novice Horse Challenge           |                                    |
| 9.30am – approx..                                       | Park Hack & Hack                 | Riding Horse                     | Saddle Hunter Horse                |
|   | SUPREME HORSE                    |                                  |                                    |
|   | Senior Rider                     |                                  | Open Horse Challenge               |
|   | Best Registered Horse            |                                  | NZTR TB A&P Show Series            |
|   | LUNCH                            |                                  |                                    |
| Not before 1pm  | Show Pony                        | Saddle Hunter Pony               | Show Pleasure Horse                |
|   |                                  |                                  |                                    |
|   | SUPREME PONY                     |                                  |                                    |
|   | Open Pony Challenge              |                                  |                                    |
|   | Best Registered Pony             |                                  |                                    |
|   | Junior Rider                     |                                  |                                    |

| <b>Sunday 23<sup>rd</sup> November</b><br><b>Time</b> | <i>Ring One</i><br><i>Judge:</i>  | <i>Ring Two</i><br><i>Judge:</i> | <i>Ring Three</i><br><i>Judge:</i>             | <i>Ring Four</i><br><i>Judge:</i>           | <i>Ring Five</i><br><i>Judge:</i>              |
|---|---|----------------------------------|--|---|--|
| 9.00am  | Rec/Leisure<br>17 yrs & over  | Rec/Leisure<br>12 – 16 yrs       | Rec/Leisure<br>8 – 11 yrs<br>(canter in group) | Rec/Leisure<br>10 yrs & under<br>(Led Rein) | Rec/Leisure<br>8 – 11 yrs<br>(canter optional) |
|   |   |                                  |  |   |  |
| Not before<br>11.30am                                 | Rec/ Leisure<br>Jumping<br><br>20cm<br>30cm<br>40cm<br>50cm<br>60cm<br>70cm | Can be led<br>Can be led         |  |   |  |

# DRESSAGE

**Thursday 20th November, 8.30am**

**Venue: Main Oval/TSB Indoor Arena**

**Entries close online with Evo Events midnight Thursday 6<sup>th</sup> November 2025**

## **RULES:**

1. All classes run under ESNZ rules.
2. All tests are from the Dressage NZ test book dated 1/9/2023.
3. All riders in graded classes Novice & Above must have Full ESNZ Membership current to 20/11/25.
4. Riders competing in Introductory Classes & Preliminary must be ESNZ Introductory Annual Member or Full Membership.
5. All ESNZ Horse/Pony registrations must be current to 20/11/25.
6. Dressage Flexi-start payable for ESNZ registered horses & ponies with no annual dressage start \$5 per test all Levels.
7. One ESNZ graded class score will qualify for Dressage Taranaki circuit points.
8. Maximum of three starts per horse.
9. Pony classes 2028/30/32/34 may only be contested by a rider 16 years and under at 1 Aug 2025
10. Pony riders 16 years and under at 1 Aug 2025 contesting any class will be eligible for the Polarlight Trophy for their two highest percentages.
11. Dressage draw will be posted on [www.egmontshowgrounds.org.nz](http://www.egmontshowgrounds.org.nz) and [www.evoevents.co.nz](http://www.evoevents.co.nz)
12. All technical dressage queries, please contact show office.
13. Entries received after draw is completed can only be accepted in the place of scratching's.
14. The organising committee reserves the right to alter the program and/or prize money within the ESNZ GR's/Dressage NZ rules or cancel classes if insufficient entries.
15. Intro, Prelim, Novice & Elementary classes may be held in the Oval. Medium, Advanced Medium classes will be held in the TSB Indoor Arena.
16. ESNZ horse registration number must be displayed at all times on both sides of the horse or pony during the dressage competition with the exclusion of Non Graded horses and ponies.
17. RAS levy of \$1.25 per entry is included into entry fee.

## **Entry Fees:**

## **Prize Money 1<sup>st</sup> – 3<sup>rd</sup>, 4<sup>th</sup> ribbon only**

|                          |          |                              |
|--------------------------|----------|------------------------------|
| Introductory/ Non-graded | \$ 15.00 | Ribbons only                 |
| Levels 1 - 5             | \$ 20.00 | 1st \$30, 2nd \$22, 3rd \$18 |

| <b>Class</b> | <b>Level/Test</b> | <b>Class</b> | <b>Level/Test</b>      |
|--------------|-------------------|--------------|------------------------|
| 2000         | Non Graded - 1.A  | 2020         | Advanced Medium - 5.A  |
| 2002         | Non Graded - 1.B  | 2022         | Advanced Medium - 5.B  |
| 2004         | Preliminary - 1.A |              |                        |
| 2006         | Preliminary - 1.B |              |                        |
| 2008         | Novice - 2.A      |              |                        |
| 2010         | Novice – 2.B      |              |                        |
| 2012         | Elementary - 3.A  | 2028         | Pony Preliminary - 1.A |
| 2014         | Elementary - 3.B  | 2030         | Pony Preliminary – 1.B |
| 2016         | Medium - 4.A      | 2032         | Pony Novice – 2.A      |
| 2018         | Medium - 4.B      | 2034         | Pony Novice – 2.B      |

# SHOW JUMPING

**Entries close online with Evo Events on Sunday 16<sup>th</sup> November at midnight.**

- For Show Hunter and non ESNZ series Show Jumping classes, prize money as per Article 248.7.

**Friday 21<sup>st</sup> November 2025**



## **Ring 1, 8.30 am, Draw Order**

|         |  |
|---------|--|
| Class 1 | Pony Welcome Stakes Art: 274 2.5.1 (Special 2 Phase) 1.20m<br>EF: \$20.00 PM: \$80, 60, 40, 20                           |
| Class 2 | Mainland Coachwork Junior Rider Series Art: 238.2.2 1.15m – 1.25m<br>EF: \$30.00 PM: \$100, 80, 60, 50, 40, 30           |
| Class 3 | The Brave Pants Company Pro-Amateur Rider Series Art: 238 2.2 1.20m – 1.30m<br>EF: \$30.00 PM: \$100, 80, 70, 60, 45, 30 |
| Class 4 | Open Horse Art. 274.2.5.1 (Special 2 phase) 1.30m<br>EF: \$30.00 PM: \$100, 80   |
| Class 5 | FMG Young Rider Series Art 238.2.2 1.25m - 1.35m<br>EF: \$30.00 PM: \$100, 80, 60, 50, 40, 30                            |
| Class 6 | Open Horse Art: 238.2.2 1.40m EF: \$40.00 PM: \$150, 120, 100  |

## **Ring 2, 8.30 am, Black Board Order**

|          |   |
|----------|---|
| Class 7  | Open Horse Art. 274.2.5.1 (Special 2 phase) 1.0m<br>EF: \$15.00 PM: \$50, 30, 20, 15                    |
| Class 8  | Open Horse Main Events 1.10 Series Art. 274.2.5.1 (Special 2 phase)<br>EF: \$15.00 PM: \$50, 30, 20, 15 |
| Class 9  | Open Horse (incl. Main-Events Tertiary Series) Art. 238.2.2 1.20m<br>EF: \$15.00 PM: \$50, 30, 20, 15   |
| Class 10 | Open Pony Art. 274.2.5.1 (Special 2 phase) 1.0m<br>EF: \$15.00 PM: \$50, 30, 20, 15                     |
| Class 11 | Open Pony Art. 274.2.5.1 (Special 2 phase) 1.10m<br>EF: \$15.00 PM: \$50, 30, 20, 15                    |



### Ring 3, 8.30am, Black Board Order

|          |             |                                  |         |         |  |
|----------|-------------|----------------------------------|---------|---------|--|
| Class 12 | Intro Pony  | Art. 274.2.5.1 (Special 2 phase) | 0.60m12 | EF:\$12 | PM: \$20, 15 Ribbons 3 <sup>rd</sup> & 4 <sup>th</sup> |
| Class 13 | Intro Pony  | Art. 274.2.5.1 (Special 2 phase) | 0.70m12 | EF:\$12 | PM: \$20, 15 Ribbons 3 <sup>rd</sup> & 4 <sup>th</sup> |
| Class 14 | Intro Pony  | Art. 274.2.5.1 (Special 2 phase) | 0.80m12 | EF:\$12 | PM: \$20, 15 Ribbons 3 <sup>rd</sup> & 4 <sup>th</sup> |
| Class 15 | Open Pony   | Art. 274.2.5.1 (Special 2 phase) | 0.90m12 | EF:\$12 | PM: \$20, 15 Ribbons 3 <sup>rd</sup> & 4 <sup>th</sup> |
| Class 16 | Intro Horse | Art. 274.2.5.1 (Special 2 phase) | 0.70m12 | EF:\$12 | PM: \$20, 15 Ribbons 3 <sup>rd</sup> & 4 <sup>th</sup> |
| Class 17 | Intro Horse | Art. 274.2.5.1 (Special 2 phase) | 0.80m12 | EF:\$12 | PM: \$20, 15 Ribbons 3 <sup>rd</sup> & 4 <sup>th</sup> |
| Class 18 | Intro Horse | Art. 274.2.5.1 (Special 2 phase) | 0.90m12 | EF:\$12 | PM: \$20, 15 Ribbons 3 <sup>rd</sup> & 4 <sup>th</sup> |

## Saturday 22<sup>nd</sup> November 2025

### Ring 1, 8.30 am Draw Order

|          |   |               |               |             |                              |
|----------|---|---------------|---------------|-------------|------------------------------|
| Class 19 | Dunstan Horse Feeds Amateur Rider Series              | Art: 238.2.2  | 1.10m – 1.20m | EF: \$30.00 | PM:\$100, 80, 60, 50, 40, 30 |
| Class 20 | NZPH Seven Year Old Breeding Series                   | Art 238.2.2   | 1.30m         | EF: \$30.00 | PM:\$100, 80, 60, 50, 40, 30 |
| Class 21 | NZ Warmblood Association Six Year Old Breeding Series | Art 238.1.1   | 1.20m         | EF:\$30.00  | \$150 Prize Pool             |
| Class 22 | TEJ Horse Mini Prix                                   | Art 238.2.2   | 1.25m - 1.35m | EF:\$35.00  | PM:\$120, 100, 80, 60, 50    |
| Class 23 | Property Brokers Horse Grand Prix Series              | Art 261.5.1.2 | 1.40m - 1.50m | EF:\$80.00  | PM:\$350 250 200 150 120 100 |
| Class 24 | AMS Saddlery Pony Grand Prix Series                   | Art 261.5.1.2 | 1.20m - 1.30m | EF:\$30.00  | PM\$100 80 60 50 40 30       |

### Ring 2, 8.30am Black Board Order

|          |   |             |                           |            |                    |
|----------|---|-------------|---------------------------|------------|--------------------|
| Class 25 | East Coast Performance Horses Five Year Old Breeding Series | Art 238.1.1 | 1.10m                     | EF:\$25.00 | \$100 Prize Pool   |
| Class 26 | Gallagher Insurance   | Open Horse  | Art 238.2.2 1.10m         | EF:\$15.00 | PM\$50, 30, 20, 15 |
| Class 27 | Stihl Shop Hawera   | Open Horse  | Art 238.2.2 1.15m - 1.20m | EF:\$15.00 | PM\$50, 30, 20, 15 |
| Class 28 | Taranaki Bulk Spreaders                                     | Open Pony   | Art 238.2.2 1.10m         | EF:\$15.00 | PM\$50, 30, 20, 15 |
| Class 29 |   | Open Pony   | Art 238.2 1.20m           | EF:\$15.00 | PM\$50, 30, 20, 15 |

### Ring 3, 8.30am, Black Board Order

|          |                         |   |             |  |
|----------|-------------------------|---|-------------|--|
| Class 30 | Eltham Vet Services     | Intro Horse   | Art 238.2.2 | 0.75m  |
|          |                         | EF:\$12.00  |             | PM:\$20, 15 Ribbon 3 <sup>rd</sup> & 4 <sup>th</sup> |
| Class 31 | Action Moto             | Intro Horse   | Art 238.2.2 | 0.85m  |
|          |                         | EF:\$12.00  |             | PM:\$20, 15 Ribbon 3 <sup>rd</sup> & 4 <sup>th</sup> |
| Class 32 | Zodiac Signs            | Open Horse  | Art 238.2.2 | 0.95m  |
|          |                         | EF:\$12.00  |             | PM:\$20, 15 Ribbon 3 <sup>rd</sup> & 4 <sup>th</sup> |
| Class 33 | Primo                   | Open Horse  | Art 238.2.2 | 1.05m  |
|          |                         | EF:\$12.00PM  |             | PM:\$20, 15 Ribbon 3 <sup>rd</sup> & 4 <sup>th</sup> |
| Class 34 | Holdem Contracting      | Intro Pony  | Art 238.2.2 | 0.60m  |
|          |                         | EF:\$12.00  |             | PM:\$20, 15 Ribbon 3 <sup>rd</sup> & 4 <sup>th</sup> |
| Class 35 | Hunts Farm Services     | Intro Pony  | Art 238.2.2 | 0.70m  |
|          |                         | EF:\$12.00  |             | PM:\$20, 15 Ribbon 3 <sup>rd</sup> & 4 <sup>th</sup> |
| Class 36 | Agtrans                 | Intro Pony  | Art 238.2.2 | 0.80m  |
|          |                         | EF:\$12.00  |             | PM:\$20, 15 Ribbon 3 <sup>rd</sup> & 4 <sup>th</sup> |
| Class 37 | Finer Spraying Services | Open Pony (incl. Egmont Horse Coaches Pony Series ) |             |  |
|          | Art 238.2.2 0.90m       | EF:\$12.00  |             | PM:\$20, 15 Ribbon 3 <sup>rd</sup> & 4 <sup>th</sup> |
| Class 38 | Health & Safety Lead    | Open Pony   | Art 238.2.2 | 1.0m   |
|          |                         | EF:\$12.00  |             | PM:\$20, 15 Ribbon 3 <sup>rd</sup> & 4 <sup>th</sup> |

# Egmont A & P Show Show Hunter Classes

Entries close 16th November 2025

| Horses   |   | Height | Entry Fee | Prize Money  |
|--|---|--------|-----------|--------------|
| <b>Friday 21st November 2025</b><br><b>8.15am arena familiarisation</b><br><b>8.30am Start</b> |   |        |           |              |
| 39   | Introductory Hunter   | 70cm   | \$8       | Ribbons only |
| 40   | Introductory Hunter   | 80cm   | \$8       | Ribbons only |
| 41   | Welcome Hunter HOYQ   | 90cm   | \$10      | \$25, 20, 10 |
| 42   | <b>LeaderBrand</b> Junior National Series                                 | 1.0 M  | \$12      | \$30, 25, 12 |
| 43   | <b>Summit Grains &amp; Saddlery</b> Amateur National Series               | 1.0 M  | \$12      | \$30, 25, 12 |
| 44   | <b>Seahorse Supplements</b> Open Equitation National Series               | 1.0 M  | \$12      | \$30, 25, 12 |
| 45   | <b>NRM</b> Open Horse National Series                                     | 1.10 M | \$12      | \$30, 25, 12 |
| <b>Ponies Category A</b>   |   |        |           |              |
| 46   | Introductory Pony   | 60cm   | \$8       | Ribbons only |
| 47   | Pony Hunter HOYQ  | 70cm   | \$10      | \$25, 20, 10 |
| 48   | <b>Vero Insurance</b> Cat A National Series                               | 70cm   | \$12      | \$30, 25, 12 |
| 49   | <b>BOP &amp; Waikato SH Groups</b> Equitation Series - 12 years and under | 70cm   | \$12      | \$30, 25, 12 |
| <b>Ponies Category B</b>   |   |        |           |              |
| 50   | Introductory Pony   | 70cm   | \$8       | Ribbons only |
| 51   | Pony Hunter HOYQ  | 80cm   | \$10      | \$25, 20, 10 |
| 52   | <b>Grains &amp; Gains</b> Cat B National Series                           | 80cm   | \$12      | \$30, 25, 12 |
| <b>Ponies Category C</b>   |   |        |           |              |
| 53   | Introductory Pony   | 70cm   | \$8       | Ribbons only |
| 54   | Pony Hunter HOYQ  | 80cm   | \$10      | \$25, 20, 10 |
| 55   | <b>Equissage NZ</b> Pony Rider Equitation Series                          | 80cm   | \$12      | \$30, 25, 12 |
| 56   | <b>The Brave Pants Company</b> Cat C National Series                      | 90cm   | \$12      | \$30, 25, 12 |
|  |   |        |           |              |



**Egmont A & P Show****Show Hunter Classes***Entries close 16th November 2025***Saturday 22nd November 2025****7.45 arena familiarisation****8.00am Start****Ponies Category A****Ponies Category A**

|    |   |      |      |              |
|----|---|------|------|--------------|
| 57 | Introductory Pony   | 60cm | \$8  | Ribbons only |
| 58 | Pony Hunter HOYQ  | 70cm | \$10 | \$25, 20, 10 |
| 59 | <b>Vero Insurance</b> Cat A National Series                               | 70cm | \$12 | \$30, 25, 12 |
| 60 | <b>BOP &amp; Waikato SH Groups</b> Equitation Series - 12 years and under | 70cm | \$12 | \$30, 25, 12 |

**Ponies Category B**

|    |   |      |      |              |
|----|---|------|------|--------------|
| 61 | Introductory Pony                               | 70cm | \$8  | Ribbons only |
| 62 | Pony Hunter HOYQ                                | 80cm | \$10 | \$25, 20, 10 |
| 63 | <b>Grains &amp; Gains</b> Cat B National Series | 80cm | \$12 | \$30, 25, 12 |

**Ponies Category C**

|    |  |      |      |              |
|----|--|------|------|--------------|
| 64 | Introductory Pony                                    | 70cm | \$8  | Ribbons only |
| 65 | Pony Hunter HOYQ                                     | 80cm | \$10 | \$25, 20, 10 |
| 66 | <b>Equissage NZ</b> Pony Rider Equitation Series     | 80cm | \$12 | \$30, 25, 12 |
| 67 | <b>The Brave Pants Company</b> Cat C National Series | 90cm | \$12 | \$30, 25, 12 |

**Horses**

|    |   |        |      |              |
|----|---|--------|------|--------------|
| 68 | Introductory Hunter   | 70cm   | \$8  | Ribbons only |
| 69 | Introductory Hunter   | 80cm   | \$8  | Ribbons only |
| 70 | Welcome Hunter HOYQ   | 90cm   | \$10 | \$25, 20, 10 |
| 71 | <b>LeaderBrand</b> Junior National Series                   | 1.0 M  | \$12 | \$30, 25, 12 |
| 72 | <b>Summit Grains &amp; Saddlery</b> Amateur National Series | 1.0 M  | \$12 | \$30, 25, 12 |
| 73 | <b>Seahorse Supplements</b> Open Equitation National Series | 1.0 M  | \$12 | \$30, 25, 12 |
| 74 | <b>NRM</b> Open Horse National Series                       | 1.10 M | \$12 | \$30, 25, 12 |





## **Showing Accumulator 2025**

Collect points from Egmont, Stratford Royal & Wanganui Shows during the 2025/26 Season

*6 Bags of Horse feed Generously Supplied by Dunstan Horse Feeds*

6 Prizes This Year – Free Entry Email: [hufalena@gmail.com](mailto:hufalena@gmail.com) for conditions and entry form

*Alternatively phone Helena McLeod Nevin 022 019 8471*

***Eligible Sections are Riding Horse, Saddle Hunter Horse & Pony, Show Hack, Park Hack, Show Pony, Lead Rein, First Ridden & Rider Classes***



## ***Hannah Gudsell - Dunstan Territory Manager***

Hawkes Bay, Poverty Bay, Taranaki, Manawatu, Wairarapa, Wellington

[Hannah@dunstan.co.nz](mailto:Hannah@dunstan.co.nz) Phone 027 292 4479

**\*\* Get in Touch with Hannah for a Personalised Nutrition Plan for your Horse or Pony \*\***

*Winning Sashes sponsored by Accumulator Organiser Helena McLeod Nevin*



# **Working Hunter Pony**

## **not exceeding 148 cm**

Friday 21st November 2025 – 10am  
Entry Fee: \$12.00 per class  
Judge: TBC

Pony Club Paddock Ring One  
Prize Money: 1st \$20; 2nd \$15; 3rd \$10

**Entries close online with Evo Events on Sunday 16<sup>th</sup> November at midnight.**

### **Section is a qualifier for Horse of the Year 2026**

Working Hunters are required to demonstrate jumping ability and be of good strong confirmation with good manners, sound paces and be a comfortable ride over long distances. They will be required to jump a minimum of three (3) hunter type fences.

Jumping style and ability 40%, confirmation 30%, paces and manners 30%.

#### **RULES:**

1. RAS Height Certificate must be carried at all times & presented upon request, otherwise the competitor will not be allowed to start.
2. Exhibit Number - It is compulsory to display your exhibit number when in the judging ring
3. Pony will be required to gallop within the confines and constraints of the venue.
4. No boots or bandages permitted.
5. One rider per pony

100 Working Hunter Pony: Novice, 0-5 wins

102 Working Hunter Pony: Open, not exceeding 138cm

104 Working Hunter Pony: Open, over 138cm & not exceeding 148cm

**Champion & Reserve Open Working Hunter Pony**  
**Winner to receive the Glynmawr Berwyn ( Snowy) Memorial Challenge Cup.**

*To be judged from winners of classes 102 & 104. Second place to the Champion to be judged alongside the remaining winner for Reserve Champion*

# **Hunter Jumping Pony**

## **not exceeding 148 cm**

Friday 21st November 2025 – To follow Working Hunter Pony      Pony Club Paddock Ring One  
Entry Fee: \$12.00 per class      Prize Money: 1st \$20; 2nd \$15; 3rd \$10  
Judge: TBC

**Entries close online with Evo Events on Sunday 16th November at midnight.**

**Section is a qualifier for Horse of the Year 2026**

### **RULES:**

1. RAS Height Certificate must be carried at all times & presented upon request, otherwise the competitor will not be allowed to start.
2. Exhibit Number - It is compulsory to display your exhibit number when in the judging ring
3. Pony will be required to gallop within the confines and constraints of the venue.
4. No boots or bandages permitted.
5. One rider per pony

150 Hunter Jumping Pony: Novice, over fences, 0-5 wins

152 Hunter Jumping Pony: Open, over fences, not exceeding 138cm

154 Hunter Jumping Pony: Open, over fences, over 138cm & not exceeding 148cm

### **Champion & Reserve Hunter Jumping Pony**

*To be judged from winners of classes 152 & 154. Second place to the Champion to be judged alongside the remaining winner for Reserve Champion*

160 Hunter Jumping Pony: The Huntman's Class  
Ponies entering this class must have hunted the past season, hunting coats are encouraged but not compulsory

162 Hunter Jumping Pony: Best Rider over fences, 14 years & under

164 Hunter Jumping Pony: Best Rider over fences, 15 & 16 years

### **Champion & Reserve Hunter Jumping Pony Rider Over Fences** **Winner to receive W.H Barkla Challenge Trophy**

*To be judged from winners of classes 162 & 164. Second place to the Champion to be judged alongside the remaining winner for Reserve Champion*

***The Taranaki A&P Hunter Jumping Challenge***  
***Sponsored by Hunter Road Stables***  
***&***  
***The Taranaki A&P Working Hunter Jumping Challenge***  
***sponsored by Mountain View Stables***

***Overall points prize of a combination of the Open Classes in Working Hunter and combination of Open Hunter Jumping classes at Egmont A&P and Stratford A&P Shows 2025.***

***Rug and cash/voucher prize to be awarded for both sections (TBA)***

***Qualifying classes***

***Working Hunter Open 148cm- 163cm***

***Working Hunter Open 163cm and over***

***Hunter Jumping Open 148cm- 163cm***

***Hunter Jumping Open 163cm and over***

***Champion and Novice classes and specialty classes excluded from series***

***First Place 4 points***

***Second Place 3 points***

***Third Place 2 Points***

***Fourth Place 1 Point.***



# Working Hunter Horse

Friday 21st November 2025 – Not before 1pm  
Entry Fee: \$12.00 per class  
Judge: TBC

Pony Club Paddock Ring One  
Prize Money: 1st \$20; 2nd \$15; 3rd \$10

**Entries close online with Evo Events on Sunday 16th November at midnight.**

## **Section is a qualifier for Horse of the Year 2026**

Working Hunters are required to demonstrate jumping ability and be of good strong confirmation with good manners, sound paces and be a comfortable ride over long distances. They will be required to jump a minimum of three (3) hunter type fences.

Jumping style and ability 40%, confirmation 30%, paces and manners 30%.

### **RULES:**

1. RAS Height Certificate must be carried at all times & presented upon request, otherwise the competitor will not be allowed to start.
2. Exhibit Number - It is compulsory to display your exhibit number when in the judging ring
3. Horse will be required to gallop within the confines and constraints of the venue.
4. No boots or bandages permitted.
5. One rider per horse

200 Working Hunter Horse: Novice, 0-5 wins

***Winner to receive Bublitz Estate Working Hunter Challenge Trophy***

202 Working Hunter Horse: Open, over 148cm & not exceeding 158cm

204 Working Hunter Horse: Open, over 158cm & not exceeding 163cm

206 Working Hunter Horse: Open, over 163cm

***Winner to receive Egmont A & P Working Hunter Cup & Dress Rug kindly sponsored by Hunter Road Stables***

*To be judged from winners of classes 202, 204 & 206*

*Second place to the Champion to be judged alongside the remaining winner for Reserve Champion*

# Hunter Jumping Horse

Friday 21st November 2025 – To follow Working Hunter horse

Entry Fee: \$12.00 per class  
Judge: TBC

Pony Club Paddock Ring One  
Prize Money: 1st \$20; 2nd \$15; 3rd \$10

**Entries close online with Evo Events on Sunday 16th November at midnight.**

**Section is a qualifier for Horse of the Year 2026**

## **RULES:**

1. RAS Height Certificate must be carried at all times & presented upon request, otherwise the competitor will not be allowed to start.
2. Exhibit Number - It is compulsory to display your exhibit number when in the judging ring
3. Horse will be required to gallop within the confines and constraints of the venue.
4. No boots or bandages permitted.
5. One rider per horse

250 Hunter Jumping Horse: Novice, over fences, 0-5 wins

252 Hunter Jumping Horse: Open, over fences, over 148cm & not exceeding 163cm

254 Hunter Jumping Horse: Open, over fences, over 163cm

256 Hunter Jumping Horse: Open, over 148cm

**Champion & Reserve Hunter Jumping Horse Dress Rug kindly sponsored  
by Hunter Road Stables**

*1st and 2<sup>nd</sup> placegetters from class 256*

262 Hunter Jumping Horse: The Huntsman Class

*Horses entering this class must have hunted the past season, hunting coats are encouraged but not compulsory.*

264 Hunter Jumping Horse: Novice Adult Rider, over fences, 0-5 wins

266 Hunter Jumping Horse: Best Rider over fences 17-20 years

268 Hunter Jumping Horse: Best Rider over fences, 21 years & over

**Champion & Reserve Hunter Jumping Horse Senior Rider Over  
Fences**

*To be judged from winners of classes 266 & 268.*

*Second place to the Champion to be judged alongside the remaining winner  
for Reserve Champion*

# Egmont A&P Thoroughbred Rising Star Award

This class is for TB's competing in their first 2 seasons of RAS Working Hunter and Hunter Jumping Classes with **no** Open wins.

- No entries accepted after entries have closed.
- Thoroughbred horse - registered in any recognised Thoroughbred Stud Book, either in NZ or overseas.
- Sire and Dam of Thoroughbred - must be listed at time of entry. If not listed, then the entry will not be accepted.

*Sponsored by*



300 Thoroughbred Rising Star Hunter Jumping Award

Entry Fee: \$12.00

Ribbons to 3<sup>rd</sup>

*Winner to receive a trophy kindly donated by Hunter Road Stables  
& Dress Rug kindly donated by LOVERACING.NZ*

302 Thoroughbred Rising Star Working Hunter Jumping Award

Entry Fee: \$12.00

Ribbons to 3<sup>rd</sup>

*Winner to receive a trophy kindly donated by Hunter Road Stables  
& Dress Rug donated by LOVERACING.NZ*





# Led Horse

Friday 21st November 2025 – Not before 10am  
Entry Fee: \$12.00 per class  
Judge: TBC

Pony Club Paddock Ring Two  
Prize Money: 1st \$20; 2nd \$15; 3rd \$10

**Entries close online with Evo Events on Sunday 16th November at midnight.**

**Section is a qualifier for Horse of the Year 2026**

## **RULES:**

1. RAS Height Certificate must be carried at all times & presented upon request, otherwise the competitor will not be allowed to start.
2. Exhibit Number - It is compulsory to display your exhibit number when in the judging ring.

400 Led Horse: Best Presented

402 Led Horse: Foal or yearling, any sex, to mature over 148cm

404 Led Horse: 2 & 3 year old, any sex, to mature over 148cm

## **Champion & Reserve Young Stock Led Horse**

*To be judged from winners of classes 402 & 404. Second place to the Champion to be judged alongside the remaining winners for Reserve Champion.*

410 Led Horse: Youngstock Best Paced and Mannered

412 Led Horse: Stallion, 4 years & over, over 148cm

414 Led Horse: Gelding 4 years & over, over 148cm

416 Led Horse: Broodmare or dry mare 4 years & over, over 148cm

## **Champion & Reserve Adult Led Horse**

*To be judged from winners of classes 412, 414 & 416.  
Second place to the Champion to be judged alongside the remaining winners for Reserve Champion*

## **Supreme Champion Led Horse**

*To be judged from the Champion Adult & Champion Young stock Led Horse  
Sponsored by: Bublitz's Estate Automotive & Air Conditioning*



424 Led Horse: Registered warmblood NZWBA  
(Must be registered with NZWBA. Proof of registration must be uploaded to your Evo Events account and documentation produced on show day if required)

*NZ Warmblood Association are sponsoring the sashes for this class*

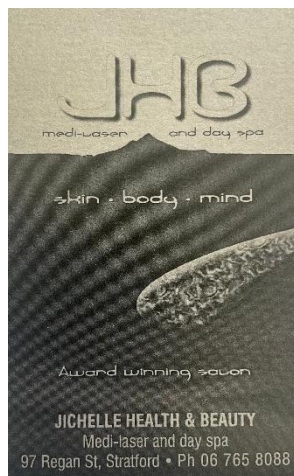

*Garland Sponsored by: Jichelle Health & Beauty*

426 Led Horse: Adult Best Paced & Mannered

428 Led Horse: Suitability for Showing classes, any age

430 Led Horse: Suitability for Dressage classes, any age

432 Led Horse: Suitability for Eventing, Show Jumping and Hunting, any age

# Led Pony not exceeding 148 cm

Friday 21st November 2025 – Not before 1pm  
Entry Fee: \$12.00 per class  
Judge: TBC

Pony Club Paddock Ring Two  
Prize Money: 1st \$20; 2nd \$15; 3rd \$10

**Entries close online with Evo Events on Sunday 16th November at midnight.**

**Section is a qualifier for Horse of the Year 2026**

## **RULES:**

1. RAS Height Certificate must be carried at all times & presented upon request, otherwise the competitor will not be allowed to start.
2. Exhibit Number - It is compulsory to display your exhibit number when in the judging ring.

500 Led Pony: Best Presented Pony & Handler

502 Led Pony: Yearling, not exceeding 140cm (any type)

***Winner to receive Kilmarnock Pony Stud Challenge Cup***

504 Led Pony: Show Pony type 2 & 3 year old, not exceeding 148cm

506 Led Pony: Saddle Hunter type, 2 & 3 years, not exceeding 148cm

### **Champion & Reserve Youngstock Led Pony**

*To be judged from winners of classes 502 & 504 & 506  
Second place to the Champion to be judged alongside the remaining  
winners for Reserve Champion*

512 Led Pony: Youngstock Best Paced & Mannered

514 Led Pony: Stallion, not exceeding 148cm

516 Led Pony: Broodmare, not exceeding 148cm

518 Led Pony: Dry Mare, 4 years & over, not exceeding 148cm

520 Led Pony: Gelding, 4 years & over, not exceeding 148cm

### **Champion & Reserve Adult Led Pony**

*To be judged from winners of classes 514, 516, 518, 520.  
Second place to the Champion to be judged alongside the remaining winners for  
Reserve Champion.*

### **Supreme Champion Led Pony**

*To be judged from Champion Adult and Champion Young Stock led Pony*

528 Led Pony: Adult Best Paced & Mannered

530 Led Pony: Registered Pure Bred Welsh

532 Led Pony: Registered Part Bred Welsh

(Classes 530 & 532 Must be registered with WPCSNZ. Proof of registration must be uploaded to your Evo Events account and documentation produced on show day if required).

534 *Led Pony: Suitability for Showing classes, any age*

536 *Led Pony: Suitability for Dressage classes, any age*

538 *Led Pony: Suitability for Eventing, Show Jumping and Hunting, any age*

# Novice Ponies not exceeding 148 cm

This section is open to ALL novice ponies – Show pony and Saddle Hunter Pony

Saturday 22nd November 2025 – 8.30 am  
Entry Fee: \$12.00 per class  
Judge: TBC

Pony Club Paddock Ring 2  
Prize Money: 1st \$20; 2nd \$15; 3rd \$10

**Entries close online with Evo Events on Sunday 16th November at midnight.**

## **RULES:**

1. RAS Height Certificate & Novice Status Cards must be carried at all times & presented upon request, otherwise the competitor will not be allowed to start.
2. Ponies to be up to and including 148cm.
3. All novice pony classes are open to riders of any age.
4. Exhibit Number - It is compulsory to display your exhibit number when in the judging ring.

600 Best Presented Novice Pony

602 Novice pony 0-2 wins

604 Novice pony 0-5 wins

### **\*\*\*\* Champion & Reserve Champion Novice Pony**

Winners from classes 602 to 604, Second placed Novice Pony to the Champion to be judged alongside the remaining winner for Reserve Champion

610 Novice Paced & Mannered Pony 0-2 wins

612 Novice Paced & Mannered Pony 0-5 wins



## Show Ponies not exceeding 148 cm

Saturday 22nd November 2025 – 1pm  
Entry Fee: \$12.00 per class  
Judge: TBC

Pony Club Paddock Ring 1  
Prize Money: 1st \$20; 2nd \$15; 3rd \$10

**Entries close online with Evo Events on Sunday 16th November at midnight.**

### RULES:

1. A Pony may only be entered in either the Show Pony Section or the Saddle Hunter Pony Section
2. RAS Height Certificate & Novice Status Cards must be carried at all times & presented upon request, otherwise the competitor will not be allowed to start.
3. Ponies to be up to and including 148cm.
4. All riders must be under 17 years of age excluding Novice classes as at 1st August 2025.
5. Exhibit Number - It is compulsory to display your exhibit number when in the judging ring.

- 650 Best Presented
- 652 Open Show Pony, not exceeding 123cm
- 654 Open Show Pony, over 123cm and not exceeding 133cm
- 656 Open Show Pony, over 133cm and not exceeding 138cm
- 658 Open Show Pony, over 138cm and not exceeding 143cm
- 660 Open Show Pony, over 143cm and not exceeding 148cm

### \*\*\*\* Champion and Reserve Champion Open Show Pony

*To be judged from classes 652 - 660. Second placed Show Pony to the Champion to be judged alongside the remaining winners for Reserve Champion  
Trophy: Arthur Brown Construction Challenge Cup*

- 668 Open Paced and Mannered Show Pony not exceeding 148cm

### \*\*\*\* Supreme Champion Pony \*\*\*\*

To be judged from both Open Champions from Show Pony & Saddle Hunter Pony Rings

- 672 **Best Registered Pony –**  
Ring 2

Prize Money: Ribbons to 4th only

Judge: TBC

To be judged under saddle. Ponies must be registered with a recognised Breed Society.  
Proof to be available to the steward upon request at the ring.

# Saddle Hunter Ponies Not Exceeding 148cm

Saturday 22nd November 2025, 1pm  
Entry Fee: \$12.00 per class

Pony Club Paddock Ring 2  
Prize Money: 1st \$20; 2nd \$15; 3rd \$10

Judge: TBC

**Entries close online with Evo Events on Sunday 16th November at midnight.**

## **RULES:**

1. A Pony may only be entered in either the Show Pony Section or the Saddle Hunter Pony Section
2. RAS Height Certificate & Novice Status Cards must be carried at all times.
3. Ponies not to exceed 148cm.
4. All riders must be under 17 years of age excluding Novice classes as at 1st August 2025.
5. All Novice pony classes are open to riders of any age.
6. Exhibit Number - It is compulsory to display your exhibit number when in the judging ring.

- 700 Best Presented
- 702 Open Saddle Hunter Pony, not exceeding 123cm
- 704 Open Saddle Hunter Pony over 123cm and not exceeding 128cm
- 706 Open Saddle Hunter Pony, over 128cm and not exceeding 133cm
- 708 Open Saddle Hunter Pony, over 133cm and not exceeding 138cm
- 710 Open Saddle Hunter Pony, over 138cm and not exceeding 143cm
- 712 Open Saddle Hunter Pony, over 143cm and not exceeding 148cm

## **\*\*\*\* Champion and Reserve Champion Open Saddle Hunter Pony**

To be judged from classes 702 - 712. Second placed Saddle Hunter Pony to the Champion to be judged alongside the remaining winners for Reserve Champion

- 718 Open Paced and Mannered Saddle Hunter Pony, not exceeding 148cm

## **\*\*\*\* Supreme Champion Pony \*\*\*\***

To be judged from both Champions from Open Show Pony & Open Saddle Hunter Pony Rings

## **672 Best Registered Pony –**

Ring 1 - Following the Open Pony Challenge

Prize Money: Ribbons to 4th only

Judge: TBC

To be judged under saddle. Ponies must be registered with a recognised Breed Society.  
Proof to be available to the steward upon request at the ring

# **Novice Pony Challenge**

## **not exceeding 148 cm**

Saturday 22nd November 2025, 8.30am      Pony Club Paddock Ring 2  
Entry Fee \$25.00  
Prize Money 1st \$75 2<sup>nd</sup> \$50 3<sup>rd</sup> \$25

The challenge comprises of two parts; the individual ridden workout, followed by presenting ponies lining up nose to tail for judging.

### **RULES:**

1. Non RAS class.
2. Riders may enter more than 1 pony, but need to have extra rider/s suitably attired & mounted to present for nose to tail component.
3. Each combination must compete in 2 other classes at the show to be eligible to compete in the Novice Challenge. One of these classes must be a Novice/Open Height class. Failure to do this will mean you forfeit any prize money & placing.
4. Entry must be a novice at the start of the 2025-2026 season
5. Adults may ride novice ponies.
6. Ponies may only enter either The Novice Pony Challenge or The Open Pony Challenge, not both.

Work out as set

- Prize for Best Presented Combination – Kindly sponsored by Dale Moseley

750 – Novice Pony Challenge

Work out as set – Can be viewed on Evo Events



# Open Pony Challenge

## not exceeding 148 cm

Saturday 22nd November 2025, following Supreme Pony Judging

Entry Fee \$25.00

Pony Club Paddock Ring 1

Prize Money 1st – \$75 2nd - \$50 3rd - \$25

Judge: TBC

The challenge comprises of two parts; the individual ridden workout, followed by presenting ponies lining up nose to tail for judging.

### **RULES:**

1. Non RAS class.
2. Riders may enter more than 1 pony but need to have extra rider/s suitably attired & mounted to present for nose to tail component.
3. Each combination must compete in 2 other showing classes to be eligible to compete in the Open Challenge. One of these classes must be a Novice/Open Height class. Failure to do this will mean you forfeit any prize money & placing.
4. Ponies may only enter either The Novice Pony Challenge or The Open Pony Challenge, not both.

760- Open Pony Challenge

- Prize for Best Presented Combination – Kindly sponsored by Dale Moseley

Work out as set – Can be viewed on Evo Events

# Rider Classes - Under 17 Years

Saturday 22nd November 2025, following Best Registered Pony

Entry Fee: \$12.00 per class

Judge: TBC

Pony Club Paddock Ring 1

Prize Money: 1st \$20; 2nd \$15; 3rd \$10

**Entries close online with Evo Events on Sunday 16th November at midnight.**

## RULES:

1. Riders may compete in rider classes from any Flat Classes section of the Show.
2. Ponies to be up to and including 148cm.
3. Local Rider: Rider must reside within area bounded by Whenuakura River, Parihaka Road, inland to Eltham - Opunake & Wiremu Road.

800 Best Novice Junior Rider, 0-5 wins

*Trophy: Golden Tan Saddlery Cup*

802 Best Rider, 11 years and under

804 Best Rider, 12, 13 and 14 years

806 Best Rider, 15 and 16 years

*Trophy: AB Cunningham Challenge Trophy*

### \*\*\*\* **Champion and Reserve Champion Junior Rider**

To be judged from the Junior winners of classes 802 to 806 Second placed Junior Rider to the Champion to be judged alongside the remaining winners for Reserve Champion

*Trophy: Catherine Mann Trophy*

812 Local Rider - No entry fee. Snaffle bridle only. Previous winner excluded. Rider under 21 years on horse or pony any height. Combination must have attended 3 Pony Club rallies in the current season.

*Trophy: Appleyard Memorial Trophy*

# Novice Horse Section

**This section is open to ALL novice horses – Park Hack, Hack, Riding Horse & Saddle Hunter Horse**

Saturday 22nd November 2025, 8.30am  
Entry Fee \$12.00 per class  
Judge: TBC

Pony Club Paddock Ring 1  
Prize Money: 1st \$20; 2nd \$15 3rd \$10

**Entries close online with Evo Events on Sunday 16th November at midnight.**

## **RULES:**

1. RAS Height Certificate & Novice Status Cards must be carried at all times & presented upon request, otherwise the competitor will not be allowed to start.
2. All horses to be over 148cm.
3. All novice classes are open to riders of any age.
4. Exhibit Number - It is compulsory to display your exhibit number when in the judging ring.

850 Best Presented Novice Horse

852 Novice Horse 0-2 wins

854 Novice Horse 0-5 wins

### **\*\*\*\* Champion & Reserve Champion Novice Horse**

Winners from classes 852 to 854, Second placed Novice Horse to be the Champion to be judged alongside the remaining winner for Reserve Champion

860 Novice Paced & Mannered Horse 0-2 wins

862 Novice Paced & Mannered Horse 0-5 wins

# Park Hacks & Hacks

Saturday 22nd November 2025, approx. 9.30am

Entry Fee \$12.00 per class

Judge: TBC

Pony Club Paddock Ring 1

Prize Money: 1st \$20; 2nd \$15 3rd \$10

**Entries close online with Evo Events on Sunday 16th November at midnight.**

## **RULES:**

1. An exhibit may only be entered in either the Show Hack or Riding Horse or Saddle Hunter section.
2. RAS Height Certificate & Novice Status Cards must be carried at all times.
3. Exhibit number - It is compulsory to display your exhibit number while in the judging ring.
4. Small Hacks must be over 148cm and not exceeding 158cm

900 Best Presented

902 Open Small Lady's Hack on Type over 148cm and not exceeding 158cm Lady or Gentleman Rider

904 Open Small Gentleman's Hack on Type over 148cm and not exceeding 158cm Lady or Gentleman Rider

906 Open Park Hack, over 148cm and not exceeding 153cm

908 Open Park Hack, over 153cm and not exceeding 158cm

### **\*\*\*\* Champion and Reserve Champion Open Park Hack**

To be judged from classes 906 & 908

Second placed Open Park Hack to the Champion to be judged alongside the remaining winner for Reserve Champion Open Park Hack.

914 Open Large Lady's Hack on Type over 158cm. Lady or Gentleman Rider

916 Open Large Gentleman's Hack on Type over 158cm. Lady or Gentleman Rider

918 Open Hack, over 158cm and not exceeding 163cm

920 Open Hack, over 163cm

### **\*\*\*\* Champion and Reserve Champion Open Hack**

To be judged from classes 918 & 920

Second placed Hack to the Champion to be judged alongside the remaining winner for Reserve Champion Open Hack.

926 Open Paced and Mannered Park Hack, over 148cm and not exceeding 158cm

928 Open Paced and Mannered Hack over 158cm

### **\*\*\*\* Supreme Champion Horse \*\*\*\***

To be judged from the Four Open Champions of the Riding Horse, Park Hack, Hack & Saddle Hunter rings

950 **Best Registered Horse (Excluding Thoroughbreds)**

Ring 1 – Following Senior Rider

Prize Money:

Ribbons to 4th only

Judge: TBC

Horses must be registered with a recognised Breed Society.

Proof to be available to the steward upon request at the ring.

This is a restricted breed class and does not count as a win for Novice Horses.

Judging criteria will be 80% Conformation, 20% Manners & Paces.

Judges will assess each horse individually and may ask for saddles to be removed after they have been assessed ridden.

952 **NZTR Thoroughbred A&P Show Series**

Ring 3 - Following Senior Rider

Judge: TBC



*Sponsored by*

**Entry Fee: \$12.00**

- No entries accepted after entries have closed.
- Thoroughbred horse - registered in any recognised Thoroughbred Stud Book, either in NZ or overseas.
- Sire and Dam of Thoroughbred - must be listed at time of entry. If not listed, then the entry will not be accepted the Show/Event
- No RAS Horse/Pony ID Certificate (Height Certificate) is required.

**Prize Money** - 1st \$100; 2nd \$50; 3rd \$30; 4th \$20 will be awarded if 3 or more entries are in the class at close of entry date. 2 entries or less - no prize money awarded.

**Ribbons** – Awarded to fourth place.

**Series Winner 2025.2026- will be announced at HOY 2026.**

**Judging:** 80% Conformation, 20% Paces & Manners.

Horses to show a good Walk and where space allows a Gallop.

Ridden horses must exhibit true thoroughbred characteristics throughout.

Judge then to assess each Horse individually with Saddles removed.

## Saddle Hunter Horse - Over 148cm

Saturday 22<sup>nd</sup> November 2025  
– Following Show Pleasure Ponies

Pony Club Paddock Ring 3

Entry Fee: \$12.00 per class  
Judge: TBC

Prize Money: 1st \$20; 2nd \$15; 3rd \$10

**Entries close online with Evo Events on Sunday 16th November at midnight.**

### **RULES:**

1. An exhibit may only be entered in either the Show Hack or Riding Horse or Saddle Hunter section.
2. Horses will be required to gallop within the confines and constraints of the venue.
3. RAS Height Certificate & Novice Status Cards must be carried at all times
4. Exhibit number - It is compulsory to display your exhibit number while in the judging ring

1000 Best Presented

1002 Open Lady's Saddle Hunter on Type. May be ridden by a Lady or Gentleman

1004 Open Gentleman's Saddle Hunter on Type. May be ridden by a Lady or Gentleman

1006 Open Saddle Hunter over 148 cm not exceeding

1008 Open Saddle Hunter over 163 cm

### **\*\*\*\* Champion and Reserve Champion Open Saddle Hunter**

*be judged from the winners of classes 1006 & 1008 Second placed Saddle Hunter to the Champion to be judged alongside the remaining winner for reserve*

1014 Open Paced and Mannered Saddle Hunter

### **\*\*\*\* Supreme Champion Horse \*\*\*\***

To be judged from the Four Open Champions of the Riding Horse, Hack & Saddle Hunter rings

950 **Best Registered Horse (Excluding Thoroughbreds)**

Ring 1 – Following Senior Ride

Prize Money: Ribbons to 4th only

Judge: TBC

Horses must be registered with a recognised Breed Society.

Proof to be available to the steward upon request at the ring.

This is a restricted breed class and does not count as a win for Novice Horses.

Judging criteria will be 80% Conformation, 20% Manners & Paces.

Judges will assess each horse individually and may ask for saddles to be removed after they have been assessed ridden.

952 **NZTR Thoroughbred A&P Show Series**

Ring 3 – Following Senior Rider

Judge: TBC

*Sponsored by*



**Entry Fee: \$12.00**

- No entries accepted after entries have closed.
- Thoroughbred horse - registered in any recognised Thoroughbred Stud Book, either in NZ or overseas.
- Sire and Dam of Thoroughbred - must be listed at time of entry. If not listed, then the entry will not be accepted the Show/Event

**Prize Money** – 1st \$100; 2nd \$50; 3rd \$30; 4th \$20 will be awarded if 4 or more entries are in the class at close of entry date. 3 entries or less – no prize money awarded.

**Ribbons** – Awarded to fourth place.

**Series Winner 2025 – 2026 will be announced at HOY 2026.**

**Judging:** 80% Conformation, 20% Paces & Manners.

Judges to assess each Horse individually with Saddles removed.

After they have been assessed, Ridden Horses to Show true Thoroughbred qualities. Horses to show a good Walk as well as Gallop (room permitting).



# Riding Horse Over 148cm **Gallagher** INSURANCE

Saturday 22<sup>nd</sup> November 2025, Following Novice Horse Challenge

Pony Club Paddock Ring 2

Entry Fee \$12.00 per class

Prize Money: 1st \$20; 2nd \$15 3rd \$10

Judge: TBC

**Entries close online with Evo Events on Sunday 16th November at midnight.**

## RULES

1. An exhibit may only be entered in either the Show Hack or Riding Horse or Saddle Hunter section.
2. Horses will be required to gallop within the confines and constraints of the venue.
3. RAS Height Certificate & Novice Status Cards must be carried at all times & presented upon request, otherwise the competitor will not be allowed to start.
4. Exhibit number - It is compulsory to display your exhibit number while in the judging ring.

1100 Best Presented

1102 Open Lady's Riding Horse, on Type. May be ridden by a Lady or a Gentleman

1104 Open Gentleman's Riding Horse on Type. May be ridden by a Lady or Gentleman

1106 Open Riding Horse, over 148cm and not exceeding 158cm

1108 Open Riding Horse, over 158cm and not exceeding 163cm

1110 Open Riding Horse, over 163cm

### \*\*\*\* **Champion and Reserve Champion Open Riding Horse**

To be judged from the winners of classes 1106 – 1110 Second placed Riding Horse to the Champion to be judged alongside the remaining winners for Reserve Champion

1116 Open Paced and Mannered Riding Horse

### \*\*\*\* **Supreme Champion Horse** \*\*\*\*

To be judged from the Four Open Champions of the Riding Horse, Hack & Saddle Hunter rings

## 950 **Best Registered Horse (Excluding Thoroughbreds)**

Ring1 – Following Senior Rider

Prize Money: Ribbons to 4th only

Judge: TBC

Horses must be registered with a recognised Breed Society.

Proof to be available to the steward upon request at the ring.

This is a restricted breed class and does not count as a win for Novice Horses.

Judging criteria will be 80% Conformation, 20% Manners & Paces.

Judges will assess each horse individually and may ask for saddles to be removed after they have been assessed ridden.



952 **NZTR Thoroughbred A&P Show Series**

Ring 3- Following Senior Rider

Judge: TBC

*Sponsored by*



**Entry Fee: \$10.00**

- No entries accepted after entries have closed.
- Thoroughbred horse - registered in any recognised Thoroughbred Stud Book, either in NZ or overseas.
- Sire and Dam of Thoroughbred - must be listed at time of entry. If not listed, then the entry will not be accepted the Show/Event

**Prize Money** – 1st \$100; 2nd \$50; 3rd \$30; 4th \$20 will be awarded if 4 or more entries are in the class at close of entry date. 3 entries or less – no prize money awarded.

**Ribbons** – Awarded to fourth place.

**Series Winner 2025 - 2026 will be announced at HOY 2026.**

**Judging:** 80% Conformation, 20% Paces & Manners.

Judges to assess each Horse individually with Saddles removed.

After they have been assessed, Ridden Horses to Show true Thoroughbred qualities. Horses to show a good Walk as well as Gallop (room permitting).

# Novice Horse Challenge

Saturday 22nd November 2025, Following Novice Pony Classes

Entry Fee \$25.00

Pony Club Paddock Ring 2

Prize Money 1st – \$75 2nd - \$50 3rd - \$25

Judge: TBC

The challenge comprises of two parts; the individual ridden workout, followed by presenting horses lining up nose to tail for judging.

## **RULES:**

1. Non RAS class.
2. Riders may enter more than 1 horse but need to have extra rider/s suitably attired & mounted to present for nose to tail component.
3. Each combination must compete in 2 other showing classes to be eligible to compete in the Novice Challenge. One of these classes must be a Novice/Open Height class. Failure to do this will mean you forfeit any prize money & placing.
4. Entry must be a novice at the start of the 2025-2026 season
5. Horses may only enter either The Novice Horse Challenge or The Open Horse Challenge, not both.

1200 – Novice Horse Challenge

- Prize for Best Presented Combination – Kindly sponsored by Dale Moseley

Work out as set – Can be viewed on Evo Events

# Open Horse Challenge

Saturday 22nd November 2025, following Supreme Horse

Pony Club Paddock Ring 3

Entry Fee \$25.00

Prize Money 1st – \$75 2nd - \$50 3rd - \$25

Judge: TBC

The challenge comprises of two parts; the individual ridden workout, followed by presenting horses lining up nose to tail for judging.

## **RULES:**

1. Non RAS class.
2. Riders may enter more than 1 horse but need to have extra rider/s suitably attired & mounted to present for nose to tail component.
3. Each combination must compete in 2 other showing classes to be eligible to compete in the Novice Challenge. One of these classes must be a Novice/Open Height class. Failure to do this will mean you forfeit any prize money & placing.
4. Horses may only enter either The Novice Horse Challenge or The Open Horse Challenge, not both.

1210 – Open Horse Challenge

- Prize for Best Presented Combination – Kindly sponsored by Dale Moseley

Work out as set – Can be viewed on Evo Events

# Senior Rider Classes

Saturday 22<sup>nd</sup> November 2025 – following Open Horse Challenge      Pony Club Paddock Ring 1  
Entry Fee \$12.00 per class      Prize Money: 1st \$20; 2nd \$15 3rd \$10

Judge: TBC

**Entries close online with Evo Events on Sunday 16th November at midnight.**

## **Section is a qualifier for Horse of the Year 2026**

- 1300 Best Novice Rider, 17 years and over, 0-5 wins
- 1302 Youth or Girl Best Rider, 17 years and under 21 years
- 1304 Best Rider, 21 years and over

### **\*\*\*\* Champion and Reserve Champion Senior Adult Rider\*\*\*\***

To be judged from winners of classes 1302 & 1304. Second placed Rider to the Champion to be judged alongside the remaining winner for Reserve Champion

# Show Pleasure Section

**Entries close online with Evo Events on Sunday 16<sup>th</sup> November at midnight.**

Please refer to the NZEPS website for more information, allowable saddlery and dress, class descriptions, how to join and upcoming shows.

<https://nzequestrianpleasure.files.wordpress.com>

## Rules.

1. Riders and mounts may be fully registered with ESNZ.
2. All Pleasure classes will be run under NZ Equestrian Pleasure Society Rules (NZEPS).
3. Classes are open to NZEPS registered riders and horses/ponies as well as to unregistered riders and horses/ponies.
4. Mounts must not have place 1st in an RAS Affiliated show in an open showing class i.e Saddle Hunter, Working Hunter etc (Dispensation can be applied for to NZEPS)
5. Not open to mounts competing in RAS showing classes.
6. Mount may be any size.
7. Adults may ride ponies in hack classes. Children on a hack must ride in the hack ring.
8. Simple Snaffle bits only may be used (as defined by Dressage NZ)
9. Whips may be used but they must not be over 76cms in length. Dressage whips are not allowed.
10. Spurs or flashes or any strapping below the bit are not to be used.
11. Competitors must adhere to RAS/NZEF rules.
12. This show is a Qualifying Show for National Regional Award Points Prize and Championship Class at NZ National Horse and Pony Show.
13. RAS Show levy of \$1.25 per entry is included in Entry Fee.

# Show Pleasure Horse

Saturday 22<sup>nd</sup> November 2025 , 1pm

Pony Club Paddock, Ring 3

Entry Fee \$12.00 per class

Prize Money: 1st \$20; 2nd \$15; 3rd \$10

Judge: TBC

**Entries close online with Evo Events on Sunday 16<sup>th</sup> November at midnight.**

- 1350 Best Presented
- 1352 Best Trot
- 1354 Best Paced & Mannered Horse
- 1356 Best Suited for a Learner Horse
- 1358 Best Combination
- 1360 Best Registered Combination (Open to NZEPS Members Only) – Ribbons supplied by NZEPS
- 1362 Best Rider 18 years and over

**\*\*\*\* Champion & Reserve Champion Pleasure Horse \*\*\*\*  
Winners from Classes 1354, 1356, 1358 & 1360**

# Show Pleasure Pony

Saturday 22<sup>nd</sup> November 2025 8.30am  
Entry Fee \$12.00 per class

Pony Club Paddock, Ring 3  
Prize Money: 1st \$20; 2nd \$15; 3rd \$10

Judge: TBC

**Entries close online with Evo Events on Sunday 16<sup>th</sup> November at midnight.**

- 1400 Best Presented
- 1402 Best Trot
- 1404 Best Paced & Mannered Pony
- 1406 Best Suited for a Learner Pony
- 1408 Best Combination
- 1410 Best Registered Combination (Open to NZEPS Members only) – Ribbons supplied by NZEPS
  
- 1412 Best Rider 17 Years and Under

**\*\*\*\* Champion & Reserve Champion Pleasure Pony \*\*\*\***  
**Winners from Classes 1404, 1406, 1408 & 1410**

# Recreational/Leisure Showing Section

*WT & LM Smyth*

**Entries close online with Evo Events on Sunday 16<sup>th</sup> November at midnight.**

## Rules

1. Plaiting and riding jackets optional, Riding or Pony Club uniform or tidy appropriate dress.
2. Helmets must be yellow tagged.
3. All mounts must have a bit in their mouth.
4. No height certificate is required.
5. The Egmont A&P Assn reserve the right to make changes/alterations to the program as required.
6. Competitors in these rings cannot enter any other Showing classes during Egmont A&P Show 2025

**Sunday 23<sup>rd</sup> November 2025**

**9.00am**

Entry Fee: \$35.00 blanket entry  
Judge: TBA

Pony Club Paddock  
Ribbons Only

## Ring 1 R/L

Recreational/Leisure Horse or Pony – Riders 17 years and over.

- |      |  |
|------|--|
| 2100 | Best Cared and Presented   |
| 2102 | Best Trot  |
| 2104 | Best Mannered  |
| 2106 | Best Combination   |
| 2108 | Horse or Pony most suited to be a pony club/riding club type mount |
| 2110 | Best Rider   |

**\*\*\* Champion and Reserve Champion Recreational Mount** (To be judged from winners of classes 2102, 2104, 2106 & 2108 with 2nd placegetters on standby)

## Ring 2 R/L

Recreational/Leisure Horse or Pony – Riders 12 to 16 years. **Canter in a group.**

- |      |   |
|------|---|
| 2200 | Best Cared and Presented                    |
| 2202 | Best Trot                                   |
| 2204 | Best Mannered                               |
| 2206 | Best Combination                            |
| 2208 | Horse or Pony most suited to be a pony club |
| 2210 | Best Rider 12 -13 Years                     |
| 2212 | Best Rider 14 -16 Years                     |

**\*\*\* Champion and Reserve Champion Recreational Mount** (To be judged from winners of classes 2202, 2204, 2206 & 2208 with 2nd placegetters on standby)

### **Ring 3 R/L**

Recreational/Leisure Led Pony or Horse – Riders 8 to 11 years. **Canter in a group**

- 2300 Best Cared and Presented
- 2302 Best Trot
- 2304 Best Mannered
- 2306 Best Combination
- 2308 Horse or Pony most suited to be a pony club
- 2310 Best Rider (may be split into age groups – entry dependent)

**\*\*\* Champion and Reserve Champion Recreational Mount** (To be judged from winners of classes 2302, 2304, 2306 & 2308 with 2nd placegetters on standby)

### **Ring 4 R/L**

Recreational/Leisure Led Pony or Horse – Riders 10 years and under on **lead rein**.

- 2400 Best Cared and Presented
- 2402 Best Trot
- 2404 Best Mannered
- 2406 Best Combination
- 2408 Learners Mount
- 2410 Best Rider (may be split into age groups – entry dependent)

**\*\*\* Champion and Reserve Champion Recreational Mount** (To be judged from winners of classes 2402, 2404, 2406 & 2408 with 2nd placegetters on standby)

### **Ring 5 R/L**

Recreational/Leisure Led Pony or Horse – Riders 8 – 11 years. Walk & trot in a group, **canter optional**.

- 2500 Best Cared and Presented
- 2502 Best Trot
- 2504 Best Mannered
- 2506 Best Combination
- 2508 Learners Mount
- 2510 Best Rider

**\*\*\* Champion and Reserve Champion Recreational Mount** (To be judged from winners of classes 5002, 5003, 5004 & 5005 with 2nd placegetters on standby)



*WT & LM Smyth*

## **Recreational/ Grass Roots Jumping**

**Sunday 23rd November 2025**

Pony Club Paddock

### **Class 6000**

Not before 11.30am

|      |            |
|------|------------|
| 20cm | Can be led |
| 30cm | Can be led |
| 40cm |            |
| 50cm |            |
| 60cm |            |
| 70cm |            |

Starting at 20cm and going up in 10cm increments to maximum height of 70cm.

Blackboard order

Recycled Ribbons for clear rounds

\$5.00 per round – max 3 rounds per mount.

Can be entered via EvoEvents or on the day (Cash only)

**Combinations cannot enter any other jumping classes during the Egmont A&P show. This does not include TEJ Spring Spectacular held on Sunday 23<sup>rd</sup> November.**